

A low-angle, upward-looking photograph of several multi-story buildings. The buildings are in various colors: a light tan one on the left, a bright red one on the right, and a yellow one at the bottom left. The sky is a clear, pale blue. The perspective creates a sense of height and grandeur.

multiply **2024**

follow
JESUS

113th Annual Gathering of
Rosedale Network of Churches

august 2-4

Woodbridge High School | Greenwood, DE

WELCOME

Welcome to the Greenwood community, affectionately known as “Slower Lower Delaware.” The community is located on the Delmarva Peninsula, with the Atlantic Ocean to the east and the Chesapeake Bay to the west. The peninsula is known for its beaches, fishing, boating, and the renowned Chesapeake Bay blue crab. Traveling south, you’ll cross into Maryland and Virginia, home to Assateague and Chincoteague Island. This is a rural community dotted with farms, chicken houses, and small towns that thrive on funds from out-of-state speeding tickets. Hosting this event are four churches spread out over 80 miles on the peninsula. We hope your trip to “The First State” will create warm—but not too warm—memories of friendly people and refreshing times of encouragement in your walk with Jesus.

—Lyn Byler, Multiply 2024 Steering Committee Chair

FOLLOW JESUS

We gather together at Multiply 2024 to experience a clear call to keep Jesus and His kingdom front and center as we live in a divided culture that pressures us to align with one worldly system or another. The theme *Follow Jesus* is especially relevant in an election year, when much focus is placed on the earthly kingdom in which we live, and in our social media-saturated culture where it’s all about who you “like” and “follow.”





WEEKEND OVERVIEW

FRIDAY 8/2

- 3:00 pm Doors Open
- 5:00 pm Supper
- 6:30 pm **Plenary Session 1**
- 8:00 pm Reception by RBC, RI, & RNOC
- TBA Youth Social

SATURDAY 8/3

- 9:00 am Children's Program
Hymn Sing
Plenary Session 2
- 9:15 am Youth Program at Gateway Fellowship
- 11 am Breakout Sessions
- 12 pm Lunch
- 12-1 pm RBC Pizza Party (Youth) at Gateway Fellowship
- 1:30 pm Breakout Sessions
- 3:00 pm Breakout Sessions
- 5:00 pm Supper
- 6:30 pm **Plenary Session 3**
- 8:00 pm Reception by local RNOC congregations
- TBA Youth Social

SUNDAY 8/4

- 9:30 am **Plenary Session 4**
Songs by Children
- 11:30 am Lunch/Dismissal

TABLE OF CONTENTS

- General Information 3
- Maps 5
- Children & Junior High 8
- Youth & Young Adults 9
- Friday Evening 11
- Saturday Morning 12
- Breakout Sessions 13
- Saturday Evening 17
- Sunday Morning 18
- Thank You 22

GENERAL INFORMATION

LOCATION

Woodbridge High School
14712 Woodbridge Road
Greenwood DE 19950

CONTACT INFORMATION

Local Coordinator

Lyn Byler
302-423-6675
lyn@bylers.com

Hospitality & Lodging Coordinator

Candace Swartzentruber
302-258-5384

Rosedale Network of Churches

9910 Rosedale Milford Center Rd
Irwin OH 43029
740-857-1234

Brian Hershberger

Executive Director
740-506-4682
brian@rosedalenetwork.org

Darren Peachey

Conference Pastor
717-250-4660
darren@rosedalenetwork.org

FIRST AID

📍 **Room 506**

Contact: Fred Mast – 302-542-7108

PRAYER ROOM

📍 **Media Center**

WIRELESS INTERNET

Access will be available on-site.

MEETING ROOM

📍 **Room 209**

This room will be available as a meeting space for committees and boards. A sign-up sheet will be posted on the door.

INTERPRETATION

Simultaneous Spanish interpretation of the messages will be available through a listening system with receiver earphones.

Earphones are available at the information table.

RECORDINGS

Recordings will be available on our website:

rosedalenetwork.org/media/video-links/

Or for purchase by request:

Bradley Maust

814-442-1754
maust980@yahoo.com

NEXT YEAR

Multiply 2025 **July 25–27**

Location: Barr Reeve Middle/High School, Montgomery IN

SUGGESTED DONATIONS

Rosedale Network's annual gathering has always been a donation-only event. There are, of course, many expenses involved in operating a conference of this size. Below is a suggested donation amount per adult to cover the cost of the conference. If you are able to do so, consider giving more to compensate for those who are not able to make a donation.

ADULTS—\$125

Covers the cost of sessions and meals for the entire weekend.

Approximately \$50 per day

CHILDREN & YOUTH

Ages 17 and under—FREE

DONATE IN ONE OF THE FOLLOWING WAYS:

- Registration table (check or credit card)
- Saturday evening offering
- Food line donation buckets
- Online - rosedalenetwork.org



WOODBIDGE FIRST FLOOR

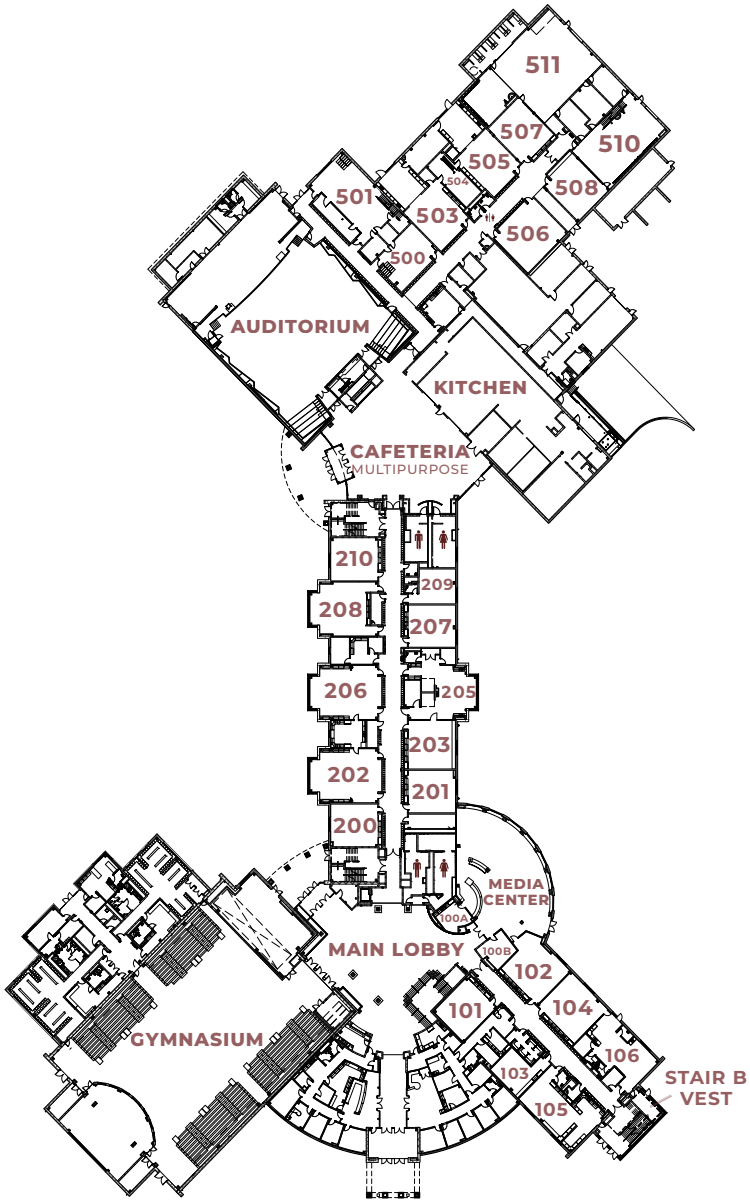

SECOND FLOOR

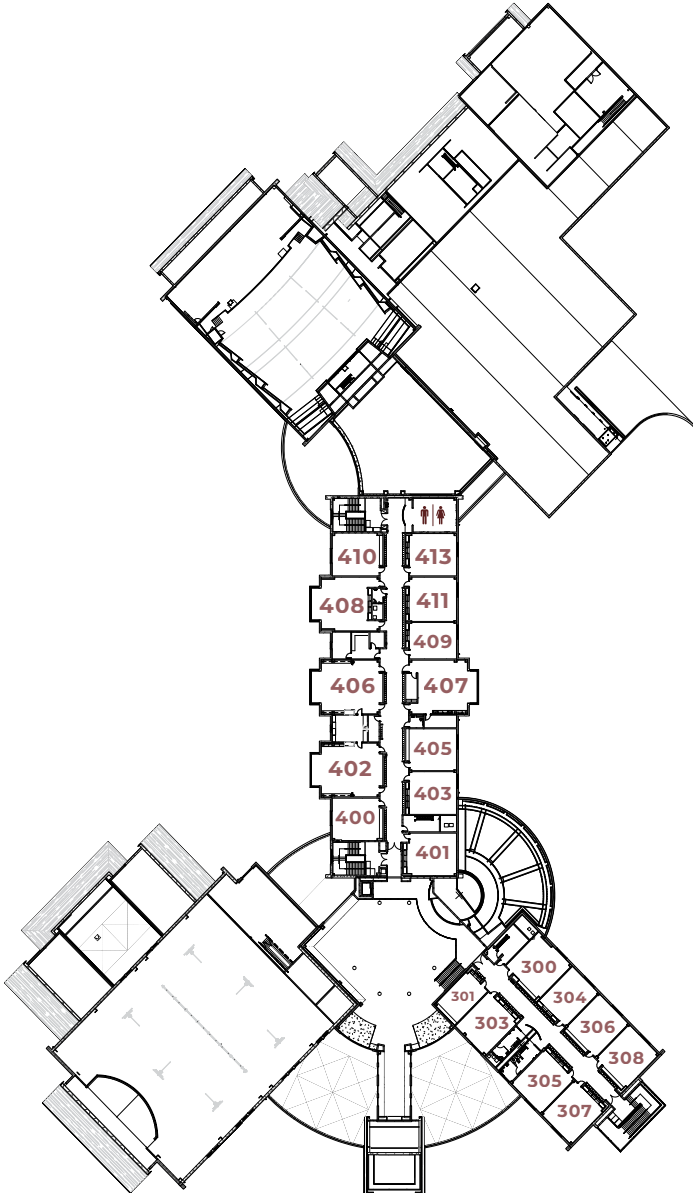

AREA MAP

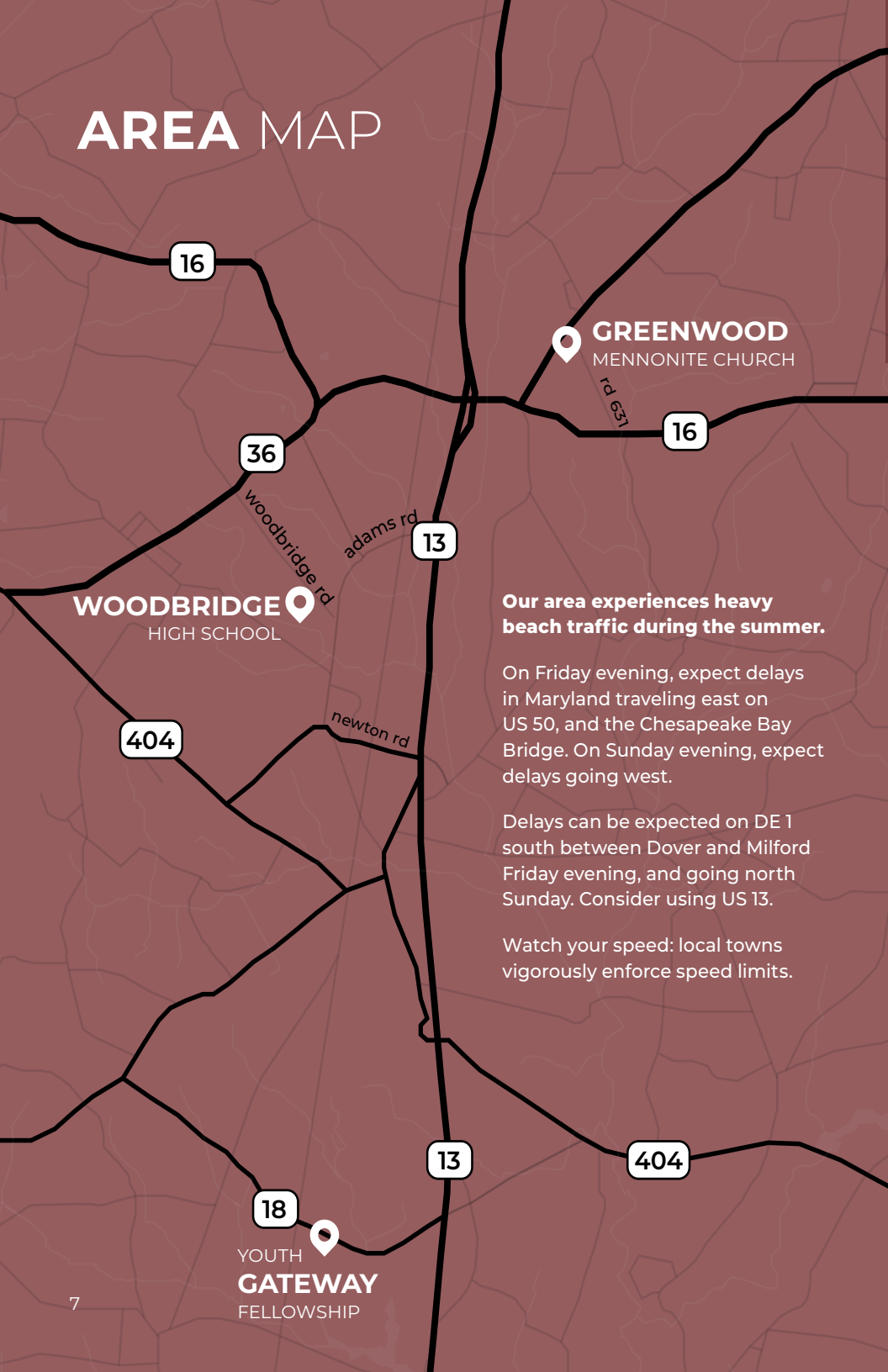

GREENWOOD
MENNONITE CHURCH

WOODBRIDGE
HIGH SCHOOL

Our area experiences heavy beach traffic during the summer.

On Friday evening, expect delays in Maryland traveling east on US 50, and the Chesapeake Bay Bridge. On Sunday evening, expect delays going west.

Delays can be expected on DE 1 south between Dover and Milford Friday evening, and going north Sunday. Consider using US 13.

Watch your speed: local towns vigorously enforce speed limits.

YOUTH
GATEWAY
FELLOWSHIP

CHILDREN & JUNIOR HIGH

SATURDAY 9:00 am–12:00 pm & 1:30–4:00 pm
SUNDAY 9:30–11:30 am (Nursery–5th grade only)

📍 Woodbridge High School



REGISTRATION & CHECK-IN

Please do not take your children directly to their meeting area without checking them in.

Check-in begins 30 minutes prior to each session.

6th–8th graders need to check in before each session, but may be dismissed directly from class with parent’s signature (acquired at check-in).

ADDITIONAL CARE

Care for nursery/preschool children will be available Friday and Saturday evenings, 6:30–8:00 pm.

Nursing Mothers 📍 **Stair B Vest**

Sleeping Nursery 📍 **Room 103**

NURSERY/PRE-K

Theme: *Follow Jesus! People in the Bible Who Followed God’s Voice*

Coordinator:

Sarah Kauffman – 302-632-0608

K-JUNIOR YOUTH

Theme: *Follow Jesus! Hear His Voice and Join the Flock*

Coordinator:

Michelle Mast – 302-542-1910

PICK-UP

Please pick up children as soon as possible following each session.

YOUTH & YOUNG ADULTS

SATURDAY 9:15 am–1:00 pm

📍 **Gateway Fellowship** – 8110 Cannon Rd, Bridgeville DE 19933

THEME: *Jesus in Your Story* – Revelation 12:11

High school-aged youth and young adults will hear the testimony of Zack Johnson, discovering how to recognize Jesus at work in their own stories. The morning includes icebreakers, worship, REACH 02 presented by RI, a pizza lunch provided by RBC, and an opportunity to see old friends and make new ones.

MORNING 9:15 am–10:45 am

Icebreakers – Rosedale International

Worship – Grove Worship

Jesus and Loving Your Enemies: “No Blood but Our Own” – Zack Johnson

DISCOVER REACH 02 10:45 am–12:00 pm

RBC PIZZA PARTY 12:00–1:00 pm

AFTERNOON 1:30–4:00 pm

📍 **Woodbridge High School** – 14712 Woodbridge Rd, Greenwood DE 19950

Youth and young adults are encouraged to attend the adult breakout sessions. *Many of the topics discussed are relevant to young people and their input is highly valued and pivotal to the life of Rosedale Network!*

YOUTH SOCIALS Fri & Sat evening

📍 **Locations/Details TBA**



ZACK is the president of Sattler College in Boston, MA. His past includes Ecuador, the military, international development, and Harvard. Now, he tries chasing enemy love after becoming a conscientious objector.



GROVE WORSHIP is a three-year-old contemporary worship team based out of Holly Grove Mennonite Church in Westover, MD. They desire to glorify God through their lives and musical excellence.



PHIL, LEXI, KARA, AND JARED are part of the Short-Term Programs department at RI. They work with young adults to help them become disciple-makers of Jesus within their communities and the least reached.



ESTHER AND ANNIKA both live in Irwin, OH, and have served as admissions counselors at RBC since 2022.



FRIDAY EVENING

PLENARY SESSION 1

6:30–8:00 pm

📍 Auditorium

Welcome

Preston Yoder, Rosedale
Network Moderator

John David Swartzentruber,
Greenwood Mennonite
Senior Pastor

Worship

led by Morgan Coblenz and
RBC Team

Offering for Rosedale Bible College

Jeremy Miller

Moderator's Address

Preston Yoder

Sermon on the Mount

Piercing Word

RECEPTION

8:00 pm 📍 Tent

Hosted by RBC, RI, RNOC

YOUTH SOCIAL

📍 Location/Details TBA



PRESTON is pastor of Shiloh Mennonite Church and moderator of RNOC. He and his wife, Liz, serve as marriage counselors. They have three young daughters and live in Plain City, OH.



JOHN DAVID is senior pastor of Greenwood Mennonite Church. He and his wife, Carlene, have four children and 11 grandchildren. As a bi-vocational pastor, John David also owns a poultry farm.

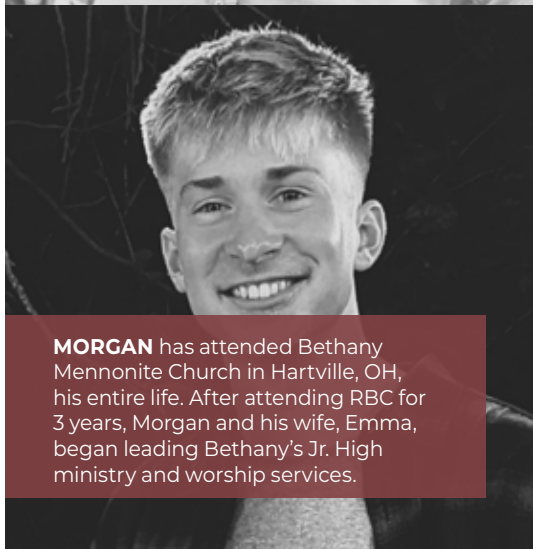

MORGAN has attended Bethany Mennonite Church in Hartville, OH, his entire life. After attending RBC for 3 years, Morgan and his wife, Emma, began leading Bethany's Jr. High ministry and worship services.

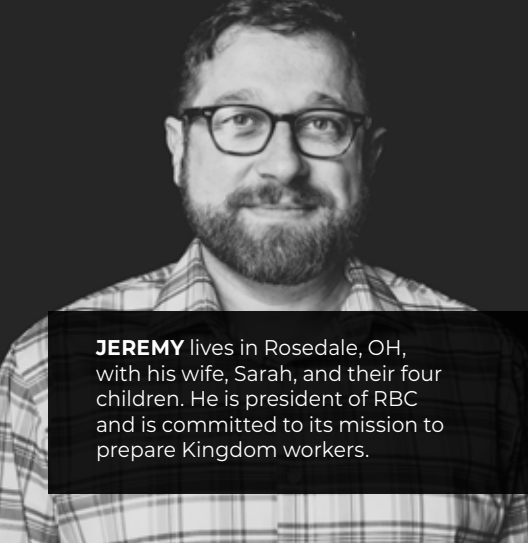

JEREMY lives in Rosedale, OH, with his wife, Sarah, and their four children. He is president of RBC and is committed to its mission to prepare Kingdom workers.



IVAN is moderator-elect of RNOC and senior pastor at Locust Grove Mennonite Church. He and his wife, Pam, are the parents of two adult children.

SATURDAY MORNING

PLENARY SESSION 2 9:00–10:30 am

📍 **Auditorium**

Welcome – Ivan Yoder

Hymn Sing – Doug Root

Introduction of New Congregations – Ivan Yoder

Two Kingdoms – Jay Mast



DOUG serves as church administrator and worship leader at Greenwood Mennonite Church, while also working as a Christian financial advisor. He is married to Kelly and has three children.



JAY is a husband, father, pastor, teacher, student, reader, and a Hicksville, OH resident who enjoys God's grace (daily), a round of disc-golf (occasionally), and cheesecake (not nearly enough).

BREAKOUT SESSIONS

SATURDAY 11:00 am–12:00 pm; 1:30–2:30 pm; 3:00 pm–4:00 pm

Two Kingdoms: A Conversation for Young Adults – Jay Mast

(11:00 am–12:00 pm) 📍 RM 206

As Christians, we are called to represent the kingdom of God amidst a diverse, modern society. The biblical concept of two kingdoms will inform our conversation as we consider practical ways to live our lives for the glory of Jesus Christ.

Scripture Memorization – Piercing Word

(11:00 am–12:00 pm) 📍 RM 210

Learn how to trade boring and ineffective Bible memorization habits for fun-filled, life-giving spiritual discipline that fosters intimacy with God. Discover practical tools and techniques for every learning style, and begin internalizing God's Word to win daily spiritual battles.

Jesus and Deliverance – Tap & Marion Ware

(11:00 am–12:00 pm; repeated 1:30–2:30 pm) 📍 RM 207

God's love empowers this transformative session! Learn to identify trauma and demonic strongholds by recognizing signs of emotional and spiritual distress, negative behavior patterns, and using discernment to detect spiritual attachments through prayer, counseling, and scriptural guidance.

Jesus and Generosity – Mark Yoder

(11:00 am–12:00 pm; repeated 1:30–2:30 pm) 📍 RM 200

We will look at the call of Jesus to lay up treasures in heaven, and the delight that comes from a heart of generosity. We will explore how giving is a spiritual gift and how money can be a powerful tool to build God's kingdom.

Jesus and Peacemaking – Preston & Liz Yoder

(11:00 am–12:00 pm; repeated 3:00–4:00 pm) 📍 RM 407 upstairs

How do we follow the teaching of Christ to be a peacemaker in our everyday lives? This workshop explores practical steps to make peace in our homes, churches, and workplaces.

Jesus and Politics – Joshua Good

(11:00 am–12:00 pm; repeated 1:30–2:30 pm) 📍 RM 208

What does it look like for God's kingdom and the kingdoms of this world to intersect? How should citizens of God's kingdom function with civil authority and responsibility? Would the government be better if Christians were in power? In this session, we will wrestle through these questions.

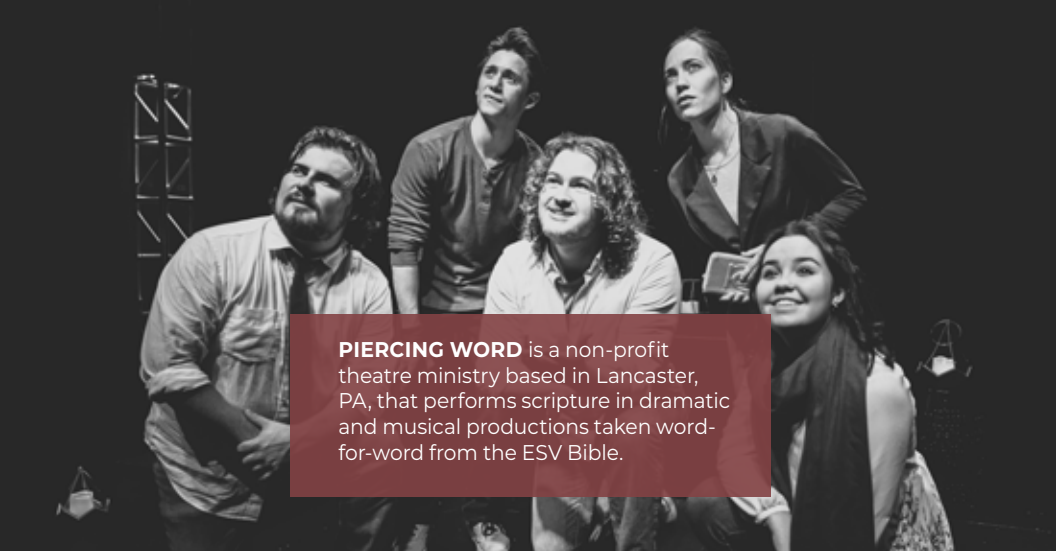

PIERCING WORD is a non-profit theatre ministry based in Lancaster, PA, that performs scripture in dramatic and musical productions taken word-for-word from the ESV Bible.



MARION & TAP have four boys and are motivated by God's love, leading lives of transformation and healing by partnering with the Holy Spirit. Tap serves as pastor of Restoration Chapel in Burton, OH.



MARK is married to Polly and has six children, 25 grandchildren, and two great-grandchildren. He recently retired as associate pastor of Greenwood Mennonite Church.



LIZ & PRESTON married in 2009 and entered full-time ministry in 2012. Blessed with different personalities and three daughters, they enjoy teaching conflict resolution.



JOSHUA lives in Lancaster County, PA, and is principal at Ephrata Mennonite School. He has a BS in History, an MA in Teaching Secondary Social Studies, and an MS in Educational Leadership. He is married and has three children.



FRANK was born and raised in New Castle, DE, and has a heart for sharing the gospel with the incarcerated. He has served with the Gospel Echoes Team Prison Ministry and has worked as a chaplain.

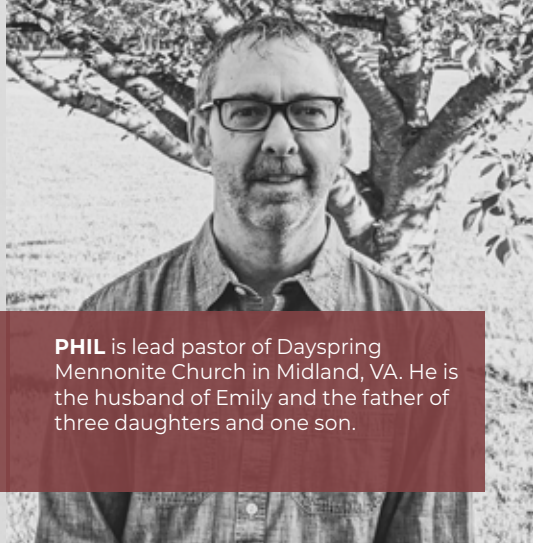

PHIL is lead pastor of Dayspring Mennonite Church in Midland, VA. He is the husband of Emily and the father of three daughters and one son.



ZACK is the president of Sattler College in Boston, MA. His past includes Ecuador, the military, international development, and Harvard. Now, he tries chasing enemy love after becoming a conscientious objector.



DION is a faculty member at RBC and teaches the course Theology of Marriage and Human Sexuality. Dion is married with four children and lives in Rosedale, OH.



CHRIS and his wife, Rose, live in Washington, IN, with their family. Chris is pastor of First Mennonite Church in Montgomery and teaches high school Spanish.



ROSEDALE INTERNATIONAL is the missional arm of RNOC. RI's vision is to see "Jesus to the World, the World to Jesus," through nurturing, equipping, and sending disciple-makers among the least reached.

BREAKOUT SESSIONS cont.

SATURDAY 11:00 am–12:00 pm; 1:30–2:30 pm; 3:00 pm–4:00 pm

Jesus and Secret Societies – Frank Pennell

(11:00 am–12:00 pm; repeated 3:00–4:00 pm) 📍 RM 201

What is a secret society? What is an oath? Are there consequences for joining a secret society, or for family members' past involvement? We will discuss what secret societies are, their consequences, and how to effectively serve and reach those involved.

Jesus and Justice – Phil Mast

(1:30–2:30 pm; repeated 3:00–4:00 pm) 📍 RM 210

Jesus lived out the perfect example of justice for us to follow. He sought out the most vulnerable in His culture and lovingly elevated their inherent value. Can we do the same today?

Jesus and Loving Your Enemies – Zack Johnson

(1:30–2:30 pm; repeated 3:00–4:00 pm) 📍 RM 406 upstairs

“No Blood but Our Own” should be the Christian mantra for enemy love and peacemaking. This session explores Jesus and enemy love through the lens of a dual-citizen missionary kid, soldier, expatriate, student, conscientious objector, educator, slave of Christ, and sinner.

Jesus and Sexuality – Dion Gingerich

(1:30–2:30 pm; repeated 3:00–4:00 pm) 📍 RM 202

How do we understand sexuality? Does Jesus have any bearing on our understanding of it? We will examine this topic from the perspective that Christianity has traditionally understood how we are to see and understand sexuality and our physical bodies.

Reaching Gen Z and Alpha for Jesus – Chris Schaefer

(3:00–4:00 pm) 📍 RM 208

Those born since 1995—Generations Z and Alpha—are a unique group requiring a distinct approach in presenting the gospel. How do we bring the reality of Jesus to generations who are used to staring at screens?

Rosedale International Field Workers – RI

(1:30–2:30 pm; repeated 3:00–4:00 pm) 📍 RM 206

Join RI workers from West Africa and the Mediterranean, as well as a new worker heading to Asia, for stories from the harvest, a time of Q&A, and cultural snacks. There will also be a time of prayer for these workers as they participate in what God is doing among unreached people groups in these regions.



BRIAN serves as executive director at RNOC. He and his wife, Sharla, live in Marysville, OH, and are involved in community outreach and worship ministry at Lighthouse Fellowship.

DARREN travels extensively with his wife, Caryn, visiting churches in his role as conference pastor of RNOC. They live in Belleville, PA, and attend Locust Grove Mennonite Church.

SATURDAY EVENING

PLENARY SESSION 3 6:30–8:00 pm

📍 Auditorium

Worship – led by Morgan Coblentz and RBC Team

Introduction of Church Plants – Brian Hershberger & Darren Peachey

Offering for Rosedale Network of Churches

Jonah – Piercing Word

Joining the Mission of Jesus – Kyle Landis

Closing – Preston Yoder, Moderator

RECEPTION

8:00 pm 📍 Tent

Hosted by local RNOC congregations

YOUTH SOCIAL

📍 Location/Details TBA



KYLE is Pastor of Church Mobilization at Fellowship Church Knoxville, TN. He has a passion for helping people find abundant life in Jesus. He is married to Kristi and has two teenagers, Mia and Micah.

SUNDAY MORNING

PLENARY SESSION 4

9:30–11:30 am

 Auditorium

Worship

led by Morgan Coblenz and RBC Team

Mission Feature

Rosedale International
Joe Showalter, Jared Chase,
Mike Baker, Devin Weaver

Offering for

Rosedale International

Merlin Miller

Songs by Children

led by Hannah Pinkham-Gilbert

Introduction of International Affiliates

Ben Shirk

Jesus to the World, the World to Jesus

Kyle Landis

Closing

Preston Yoder, Moderator

LUNCH/DISSMISSAL 11:30 am

NEXT YEAR

Multiply 2025 **July 25–27**

Location: Barr Reeve Middle/
High School, Montgomery IN



JOE is president of RI and has been an RNOC minister since 1989. He lives in Columbus, OH, with his wife, Janice, and together they lead the Columbus Network of Microchurches.



MERLIN is married to Heidi and the father of seven children. They reside in Shipshewana, IN, and he pastors Riverview Christian Fellowship in White Pigeon, MI.



BEN has served as International Liaison for RNOC since 2006. He enjoys visiting and participating with churches that Jesus is raising and maturing in different parts of the world.





THANK YOU

To the hosting churches of Multiply 2024:

We extend a heartfelt THANK YOU to the many volunteers who have planned, implemented, and hosted Rosedale Network of Churches' annual gathering this summer! Your countless hours of service are a gift to all of us.

Greenwood Mennonite Church
Maranatha Fellowship
Gateway Fellowship
Holly Grove Mennonite Church

A special thanks to the Steering Committee:

Lyn Byler, Chair
Josh Kauffman
Scott Kauffman
Fred Mast
Stuart Mast
Doug Root

To the chairs of the subcommittees:

Randy Classen, Audio/Visual
Sarah Kauffman, Nursery & Preschool Children
Michelle Mast, School-age Children
Melinda Geiser, Youth
Stephanie Yutzy, First Aid
Kim Bryfogle, Food
Everett Warfel, Grounds/Transportation
Candace Swartzentruber, Hospitality
Kendall Landis, Parking
Joshua Burke, Ushers
Beth Yatuzis, Prayer

With gratitude,



Brian Hershberger, Executive Director, Rosedale Network of Churches



**Rosedale
Network of Churches**

a global family of Anabaptists

9910 Rosedale Milford Center Rd
Irwin, OH 43029

(740) 857-1234 rosedalenetwork.org